

# Mini pressure gauge, copper alloy, plastic case

## Models PB25.050

- Case/socket enclosure prevents dust, water, and corrosion
- Direct drive technology for excellent shock resistance
- Silicone-dampened coil (option) resists vibration effects
- Easy installation using wrench flats

## Features

- High impact-resistant polycarbonate window
- Reliability under rugged operating conditions
- ABS case material that is enduring and attractive
- Cost effective solution
- Customizable dials
- No gears or bearing to wear out



## Application

- Air Inflators / Compressors
- Mini FRL's
- Pneumatic stack valves
- Medical/dental equipment
- Specialized OEM Equipment

## Specifications

**Nominal size in mm**

25

**Accuracy Class**

±5% of span

**Measuring ranges**

0 ... 20bar

**Operating temperature range**

Ambient: -20 ... +60°C

Medium: +60°C maximum

## Standard Version

**Process connection**

Copper alloy, 1/8NPT

**Connection location**

Center back

**Pressure element**

Copper alloy

**Movement**

Copper alloy

**Dial**

Aluminium, white,

Dial marking black and red

**Pointer**

Aluminium, black

**Case**

ABS

**Window**

ABS, Integrated with the case

**Options**

- Other process connection, the connection thread can be PT, G, BSPT etc.
- Special scales
- Other special versions
- Stainless steel case

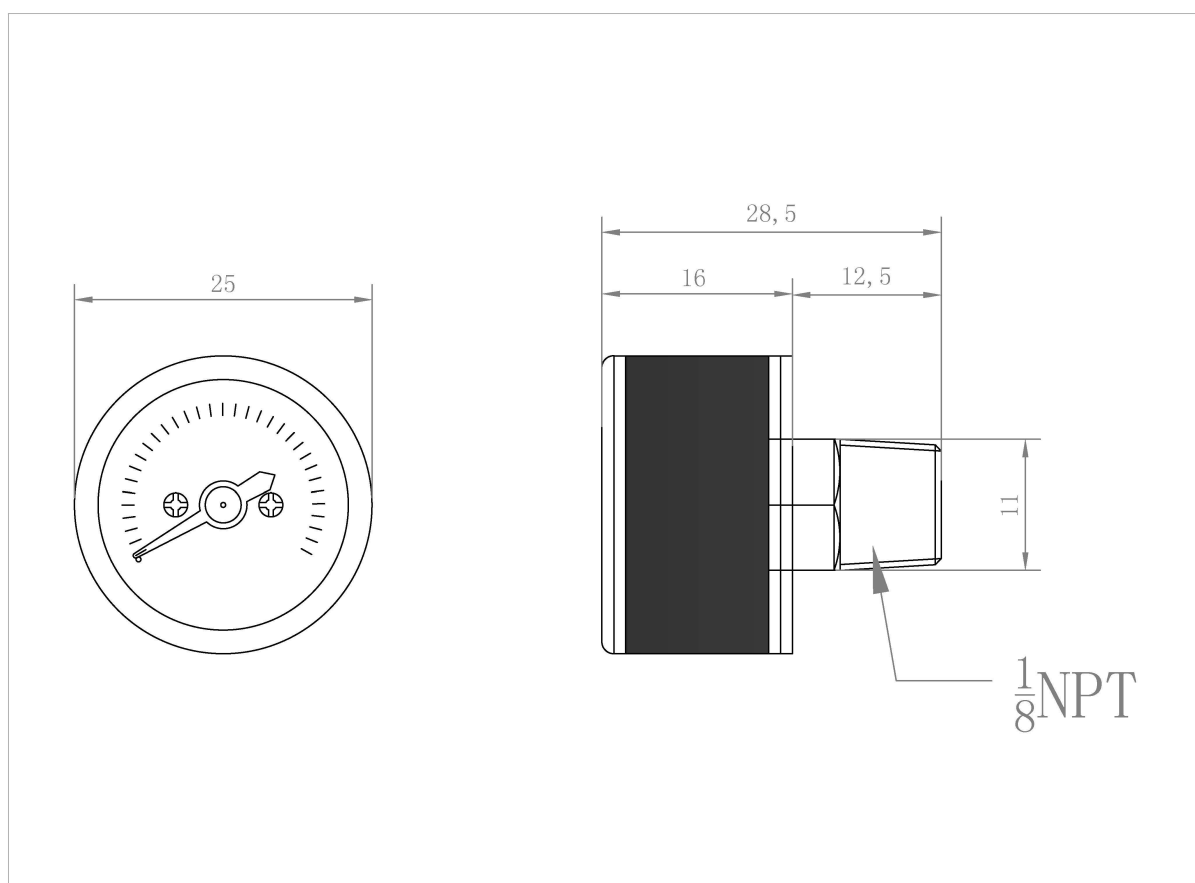
**DIMENSIONS****Order information**

Model / Nominal size / Scale range / Process connection / Connection location / Options